



Dress Code (DC): Full Uniform (refer to website or section leader)

ALL TIMES CENTRAL

Friday, August 19, 2022

9:40 AM Pep Rally
 11:00 AM 2nd Block Load Instruments on Truck
Loading Dock
 1:15 PM 3rd Block Load Instruments on Truck
 3:20 PM Percussion Load Instruments on Truck
 4:45 PM Full Band Call Time in 10-12 Band Room
 5:00 PM Full Band Loads Busses
 5:15 PM Busses Depart
 5:50 PM Busses Arrive at Hazel Green High School
 7:00 PM Kick Off- Go Senators!
 10:00 PM Load Instruments on Truck
 10:15 PM Load Busses
 10:30 PM Busses Depart for SHS
 11:00 PM Unload Busses and Truck
 11:15 PM Return Uniforms in Band Room

STADIUM INFORMATION

Hazel Green High School
 14380 US-231
 Hazel Green, AL 35750

ITEMS TO REMEMBER:

- All Uniform Parts
 - Grey 2022 Show Shirt
 - Black Compression Shorts
 - Bibbers
 - Jacket
 - Shako
 - Black Socks
 - Black Band Shoes
 - Black Gloves
- Instrument / Accessories
- Flags / Rifles / Batons

BUS ASSIGNMENTS

TBA

ALL TIMES AND LOCATIONS ARE SUBJECT TO CHANGE

THREE BEFORE ME RULE – Ask any questions in the following order before asking a director

1. Ask another band member
2. Ask your section leader
3. Ask a drum major
4. Ask a band parent
5. LAST RESORT- Ask a band director

HAZEL GREEN HIGH SCHOOL

14380 Hwy 231-431 North, Hazel Green, AL 35750
(256)851-3220 Fax: (256)851-3221 @HazelGreenHigh

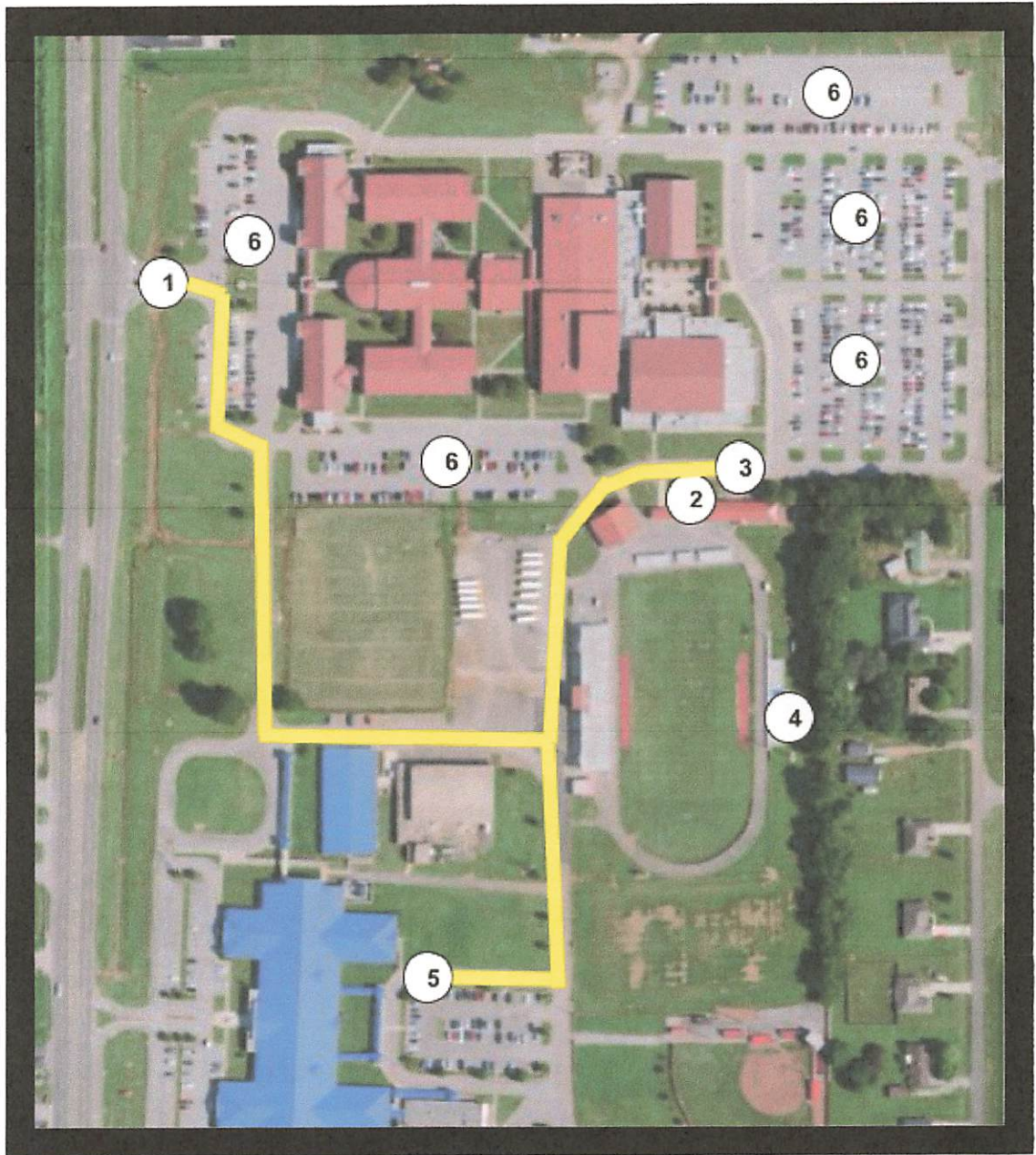

- | | |
|--|----------------------------|
| 1. Main Entrance | 4. Visitor Team Press Box |
| 2. Visitor Team Locker Room | 5. Visitor Team Band Buses |
| 3. Visitor Team Buses | 6. General Parking |
| — Direction of Visitor Team and Band Buses | |