



Sparkman High
School Bands
2616 Jeff Rd
Harvest, Al 35749

March 17, 2018

Greeting Directors and Staff,

Welcome to the first ever Rocket City Blast. We are so glad you choose to come to our show. We are working very hard to make sure our contest is ran to give you and your students the best experience possible. Through out the rest of this packet you will find the information concerning our contest, including a contest flow chart. If you have any questions please feel free to contact Robbie Stout at rstout@madison.k12.al.us. Again we are extremely happy you are attending our show and we hope you enjoy your time at Sparkman High School.

Can't wait to see your group!!!

Emergency Contact

Robbie Stout – Band Director (256) 335-0445

Denise Canfield – Booster President (256) 652-1231

Contest Time

Please find the schedule located on the SCGC website.

Admission

Per SCGC guidelines, admission will be \$10 per armband. We will be accepting **cash only**.

Staff and Chaperone Passes

Five staff/chaperone passes will be available at unit check in. Two SCGC director's badges will also be honored.

Unit Check In

Unit check in is located at the back of the school by the Gym 2 entrance. Please consult the attached map.

Parking

Spectator parking is at the front and side of the school. Bus and equipment parking will be at the back of the school. We will have guides to direct you. Please consult attached map.

Prop Unloading and Storage

Prop and floor storage will be located in the hallway next to unit check-in. Please consult the attached map. Overflow storage will be available in the Bandroom. After you perform you will push everything **OUTSIDE**. Please be weather savvy and prepare your performers accordingly.

Warm Up

Body and Equipment Warm Up will be in Gym 2.

Floor Folding

We will have an area marked off for floor refolding as you exit Gym 1. Please see attached map for details.

Competition Floor Area

This is a high school gym with two floors for seating, upper and lower deck, on both sides.

You will enter the competition floor from back right and exit back left with a **VERTICAL** time line.

Hospitality

Our hospitality room will be in the media center and open only to directors and staff with appropriate badges. We will have a separate room set up for bus drivers. Please consult attached map.

Concessions/Cafeteria

Our concession stand will be open all day. The **main** concessions will be in the cafeteria. We will offer a limited menu at the concession stand beside the gym. Our concession stands accept cash only.

First Aid

Medical staff will be on site all day. Please see attached map for location.

Retreat

Commanding officers will line up in the warm up area and be escorted into the large gym. Please consult the SCGC schedule.

Critique

Critique will be in the Hospitality Room. Please consult the SCGC schedule.

Driving Directions to:

Sparkman High School
2616 Jeff Rd.
Harvest, Al 35749

FROM BIRMINGHAM:

Take I-65 North
Take I-565 East toward Huntsville
Take Exit 14 Research Park blvd
Go west on US 53
Turn Left on Jeff Rd.
School is about a mile on your

FROM NASHVILLE:

Take I-65 South toward Alabama
Take Exit 1 and travel East on US 53
(23 miles)
Turn Right on Jeff Rd.
School is about a mile on your right.

Sparkman High School

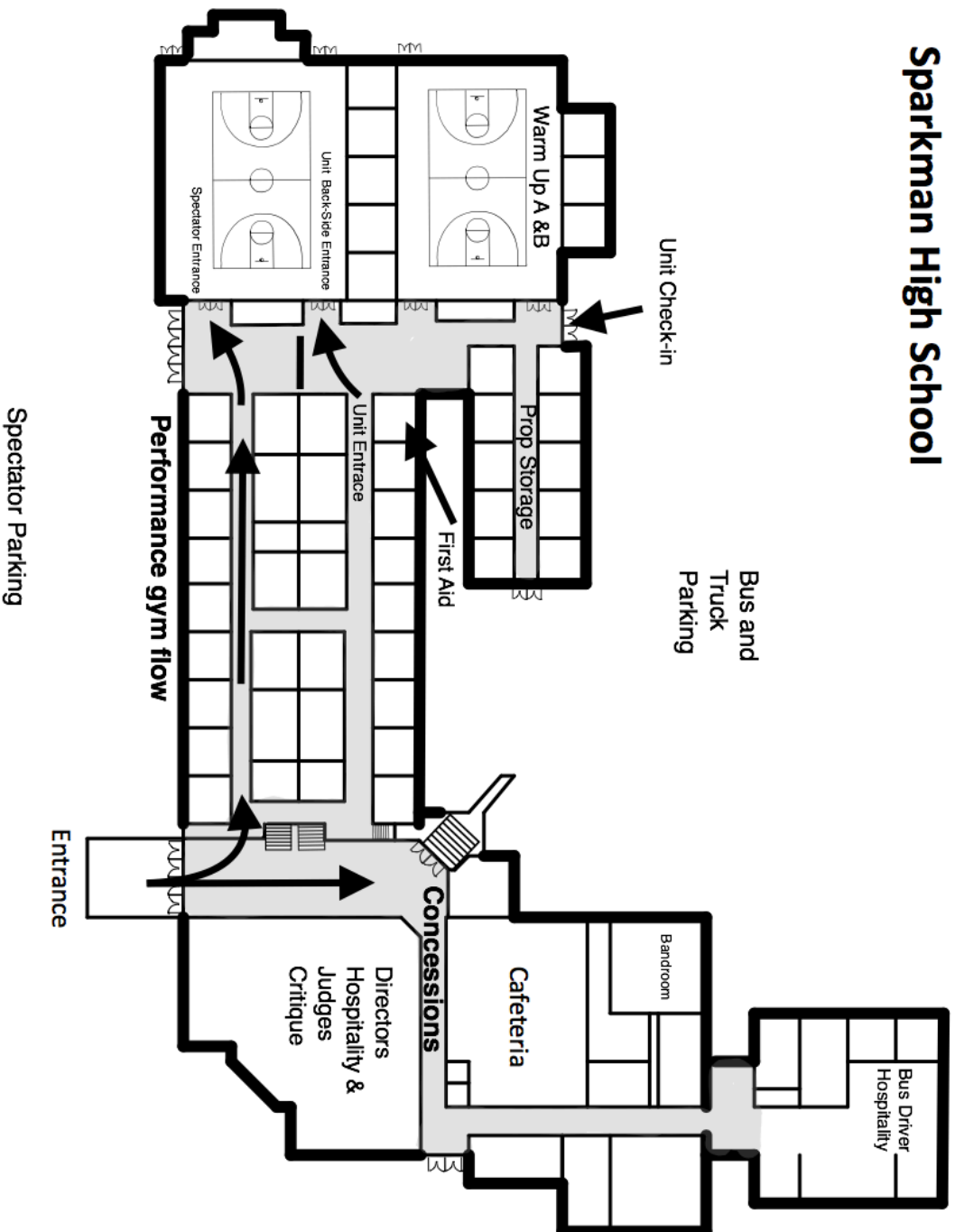

Guard Contest Flow Chart

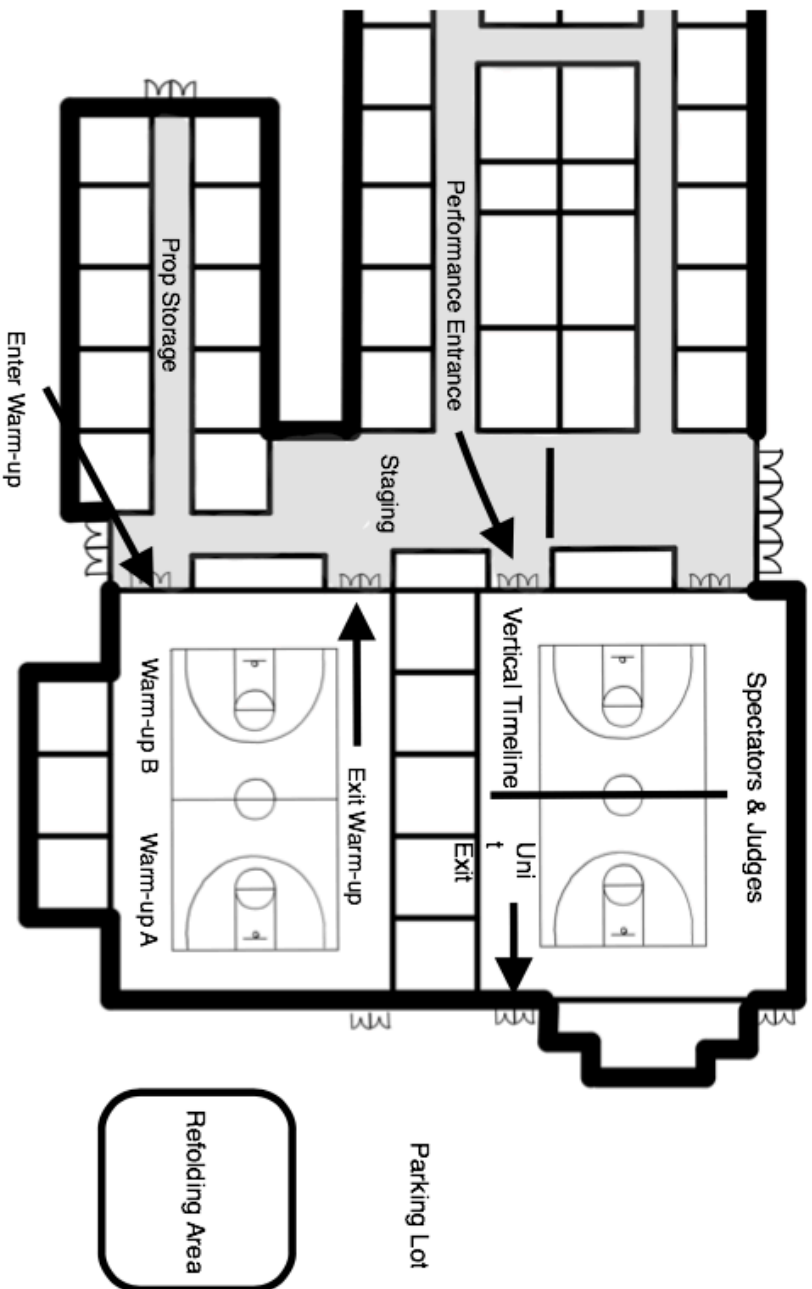

Sparkman HS Campus Map

Equipment
Bus
Entrance

Cafeteria

Spectator
Entrance

Spectator
Parking

Staging

Spectator
Parking

Equipment
and
Bus
Parking

Spectator
Parking

Gym 2

Gym 1

Spectator
Entrance

